

Model

Designation **CU SC15CLX.2 MG_Z 230/1/50 CAP**



Sales code: 314L4002

Engineering code: CUSC15CLX20CE

Application Data

Power supply	220-240V / 50Hz 1~
Refrigerants	R404A-R452A
Refr. charge - tech. limit	1300g / 45,9oz
Starter	HST / capillary tube or expansion valve
Sound pressure (10m)	34,6dB(A)

Configuration data

	Conf. 1	Conf. 2
Voltage range	198 - 254V / 50Hz	198 - 254V / 50Hz
Refrigerant	R404A	R452A
Application	LBP	LBP
Rated performance	<u>pe=-25°C, Tsuc=20°C, Tamb=25°C, subccoling: 2K</u>	
Cooling capacity	732W / 2499Btu/h	688W / 2348Btu/h
Power consumption	563,1W	527,7W
Current consumption	3,7A	3,4A
COP/EER	1,3 / 4,44Btu/Wh	1,3 / 4,45Btu/Wh
Approvals	CE, UK CA, VDE	CE, UK CA, VDE

Compressor

Designation	SC15CLX.2
Motor configuration	CSIR
Locked rotor amperage	20,43A
Rated load amperage	3,9A
Winding resistance main	3,7Ω
Winding resistance aux	14Ω
Oil quantity	500cm ³ / 16,9fl.oz
Oil type	POE
Horsepower rating	3/4 HP

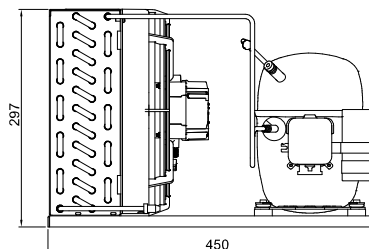

Dimensions

Condensing unit

Height x Width x Depth	297 x 350 x 450 [mm] / 11,7 x 13,8 x 17,7 [in]
Weight	20kg / 44,1lbs
Suction adapter	OD ø10mm / 2/5in
Discharge adapter	OD ø6mm / 1/4in
Process connector	ø6,2mm / 0,24in

Package data

Height x Width x Depth	350 x 450 x 550 [mm] / 13,8 x 17,7 x 21,7 [in]
Weight	23kg / 50,7lbs

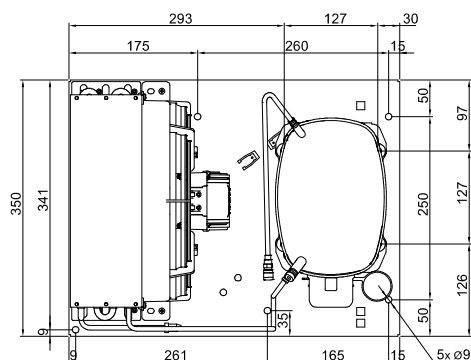

Model

Designation **CU SC15CLX.2 MG_Z 230/1/50 CAP**

Sales code: 314L4002

Engineering code: CUSC15CLX20CE

Components Condensing-Unit / Spare Parts

Component	Type	Spare part code number
Compressor code	SC15CLX.2	104L2890
Condenser	Condenser (4 rows x 11 tubes)	SP 314S0004
Fan motor		MP 314S0017
Blade code	ø254mm 28°	SP 314S0027
Air flow	576,9m³/h	
Receiver code	not installed	-/-
Suction valve code	OD ø10mm / 2/5in	-/-
Liquid valve code	OD ø6mm / 1/4in	-/-

Compressor starting equipment	Spare part code number
pos. a2 - relay	117U6019
pos. c - start capacitor (80µF)	117U5017
pos. d - cord relief	103N1004
pos. b - plastic cover	103N2009

Wiring Sketch Compressor

Wiring Sketch Condensing Unit

CSIR

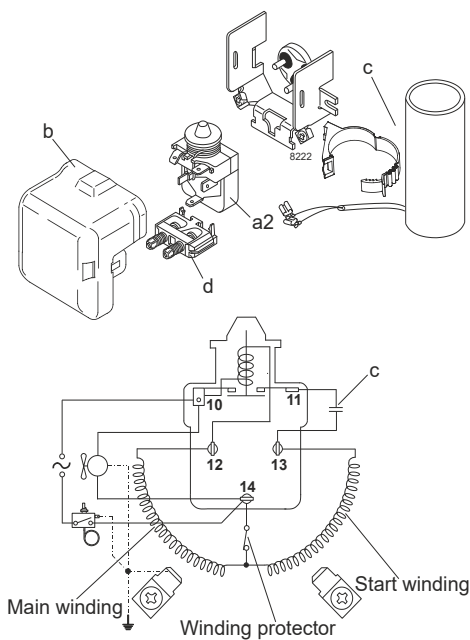

Model

Designation **CU SC15CLX.2 MG_Z 230/1/50 CAP**

Sales code: 314L4002

Engineering code: CUSC15CLX20CE

Cooling performance - Conf. 1

Power supply	220-240V / 50Hz 1~	Voltage range	198 - 254V / 50Hz
Refr. charge - tech. limit	1300g / 45,9oz		
Starter	HST / capillary tube or expansion valve		
Motor configuration	CSIR		
Refrigerant	R404A		
Application	LBP		
Approvals	CE, UK CA, VDE		

ambient temperature	°C / °F	25 / 77 (suction gas temperature [°C / °F]: 20 / 68, subcooling: 2K)						
evaporating temperature	[°C / °F]	-45 / -49	-40 / -40	-35 / -31	-30 / -22	-25 / -13	-20 / -4	-10 / 14
cooling capacity	[W]	269	361	469	593	732	885	1226
COP	[W/W]	0,81	0,94	1,06	1,19	1,3	1,4	1,54
cooling capacity	[Btu/h]	917	1231	1600	2024	2499	3023	4186
power consumption	[W]	334	386	441	500	563	633	796
current consumption	[A]	3,1	3,2	3,4	3,5	3,7	4	4,5

ambient temperature	°C / °F	32 / 90 (suction gas temperature [°C / °F]: 20 / 68, subcooling: 2K)						
evaporating temperature	CE, / °F	-45 / -49	-40 / -40	-35 / -31	-30 / -22	-25 / -13	-20 / -4	-10 / 14
cooling capacity	[W]	219	304	403	516	642	780	1086
COP	[W/W]	0,67	0,79	0,91	1,02	1,11	1,2	1,32
cooling capacity	[Btu/h]	749	1040	1377	1762	2192	2663	3707
power consumption	[W]	328	386	445	508	576	650	822
current consumption	[A]	3	3,2	3,4	3,6	3,8	4	4,6

ambient temperature	°C / °F	38 / 100 (suction gas temperature [°C / °F]: 20 / 68, subcooling: 2K)						
evaporating temperature	[°C / °F]	-45 / -49	-40 / -40	-35 / -31	-30 / -22	-25 / -13	-20 / -4	
cooling capacity	[W]	176	255	346	449	563	688	
COP	[W/W]	0,55	0,67	0,77	0,87	0,96	1,03	
cooling capacity	[Btu/h]	601	871	1181	1533	1923	2349	
power consumption	[W]	320	383	448	516	588	667	
current consumption	[A]	3	3,2	3,4	3,6	3,8	4,1	

ambient temperature	°C / °F	43 / 109 (suction gas temperature [°C / °F]: 20 / 68, subcooling: 2K)						
evaporating temperature	[°C / °F]	-45 / -49	-40 / -40	-35 / -31	-30 / -22	-25 / -13		
cooling capacity	[W]	140	213	297	392	496		
COP	[W/W]	0,45	0,56	0,66	0,75	0,83		
cooling capacity	[Btu/h]	476	729	1016	1338	1694		
power consumption	[W]	311	379	449	521	599		
current consumption	[A]	3	3,2	3,4	3,6	3,8		

Model

Designation **CU SC15CLX.2 MG_Z 230/1/50 CAP**

Sales code: 314L4002

Engineering code: CUSC15CLX20CE

Cooling performance - Conf. 2

Power supply	220-240V / 50Hz 1~	Voltage range	198 - 254V / 50Hz
Refr. charge - tech. limit	1300g / 45,9oz		
Starter	HST / capillary tube or expansion valve		
Motor configuration	CSIR		
Refrigerant	R452A		
Application	LBP		
Approvals	CE, UK CA, VDE		

ambient temperature	°C / °F	25 / 77							(suction gas temperature [°C / °F]: 20 / 68, subcooling: 2K)
evaporating temperature	[°C / °F]	-45 / -49	-40 / -40	-35 / -31	-30 / -22	-25 / -13	-20 / -4	-10 / 14	
cooling capacity	[W]	244	331	433	553	687	838	1177	
COP	[W/W]	0,79	0,92	1,05	1,18	1,3	1,41	1,56	
cooling capacity	[Btu/h]	832	1129	1480	1887	2348	2861	4021	
power consumption	[W]	310	359	411	467	528	595	754	
current consumption	[A]	2,8	2,9	3	3,2	3,4	3,6	4,2	

ambient temperature	°C / °F	32 / 90							(suction gas temperature [°C / °F]: 20 / 68, subcooling: 2K)
evaporating temperature	CE, / °F	-45 / -49	-40 / -40	-35 / -31	-30 / -22	-25 / -13	-20 / -4	-10 / 14	
cooling capacity	[W]	198	279	373	482	605	740	1047	
COP	[W/W]	0,65	0,78	0,9	1,02	1,12	1,21	1,34	
cooling capacity	[Btu/h]	675	952	1275	1647	2065	2528	3577	
power consumption	[W]	304	358	414	474	540	611	779	
current consumption	[A]	2,8	2,9	3	3,2	3,4	3,7	4,3	

ambient temperature	°C / °F	38 / 100							(suction gas temperature [°C / °F]: 20 / 68, subcooling: 2K)
evaporating temperature	[°C / °F]	-45 / -49	-40 / -40	-35 / -31	-30 / -22	-25 / -13	-20 / -4	-10 / 14	
cooling capacity	[W]	158	234	321	421	532	656	934	
COP	[W/W]	0,53	0,66	0,77	0,88	0,97	1,05	1,16	
cooling capacity	[Btu/h]	541	798	1097	1436	1819	2240	3189	
power consumption	[W]	296	355	416	481	551	627	804	
current consumption	[A]	2,7	2,9	3	3,2	3,5	3,7	4,4	

ambient temperature	°C / °F	43 / 109							(suction gas temperature [°C / °F]: 20 / 68, subcooling: 2K)
evaporating temperature	[°C / °F]	-45 / -49	-40 / -40	-35 / -31	-30 / -22	-25 / -13	-20 / -4		
cooling capacity	[W]	126	196	277	369	471	584		
COP	[W/W]	0,44	0,56	0,66	0,76	0,84	0,91		
cooling capacity	[Btu/h]	429	670	947	1259	1609	1994		
power consumption	[W]	287	351	417	486	561	641		
current consumption	[A]	2,7	2,9	3	3,2	3,5	3,8		